

Za tehnično podporo ali pomoč pokličite
090-6009



Zebra DS8178 Quick Start Guide

Več informacij: <http://bit.ly/citalec-Zebra1203>

Vprašanja? Kontaktirajte naše strokovnjake



090-6009



servis@info-kod.si



<http://www.info-kod.si>

Ponedeljek – Petek od 9:00 do 15:00

LS1203

Quick Start Guide

<http://www.zebra.com/ls1203>

STEP 1 - ATTACH CABLE TO SCANNER

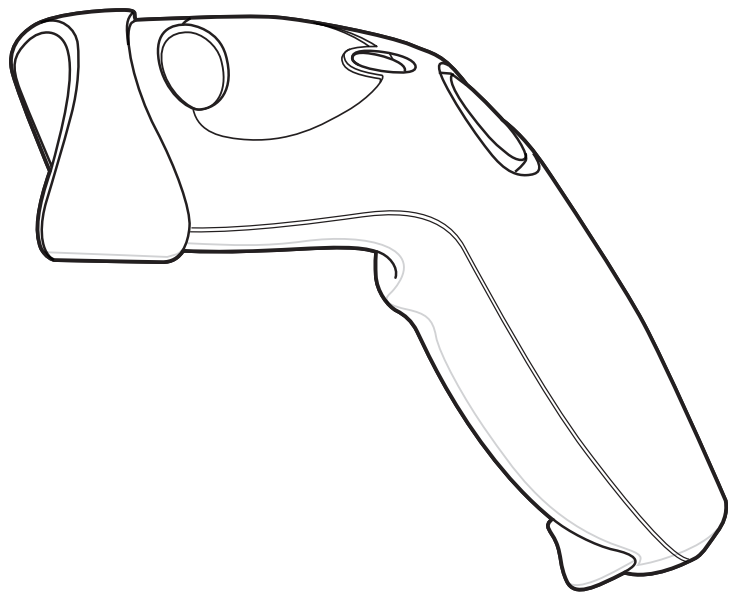

Attach Cable

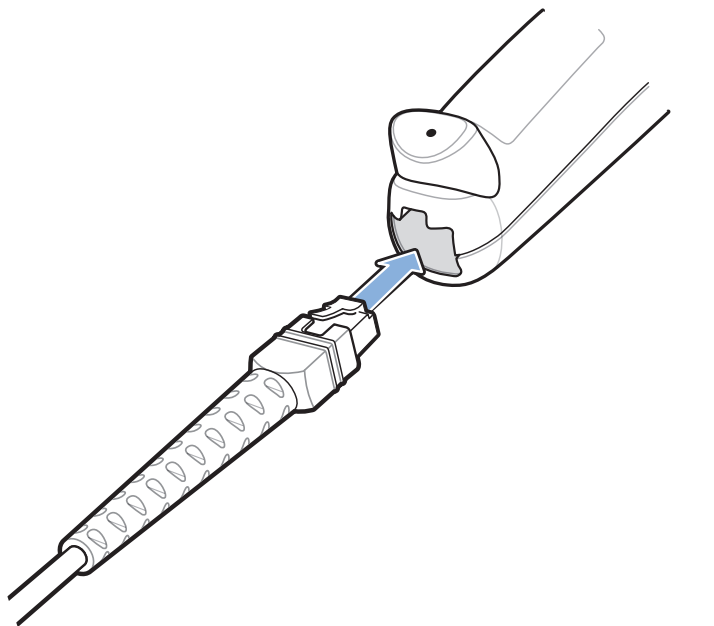

Remove Cable (to change interface)

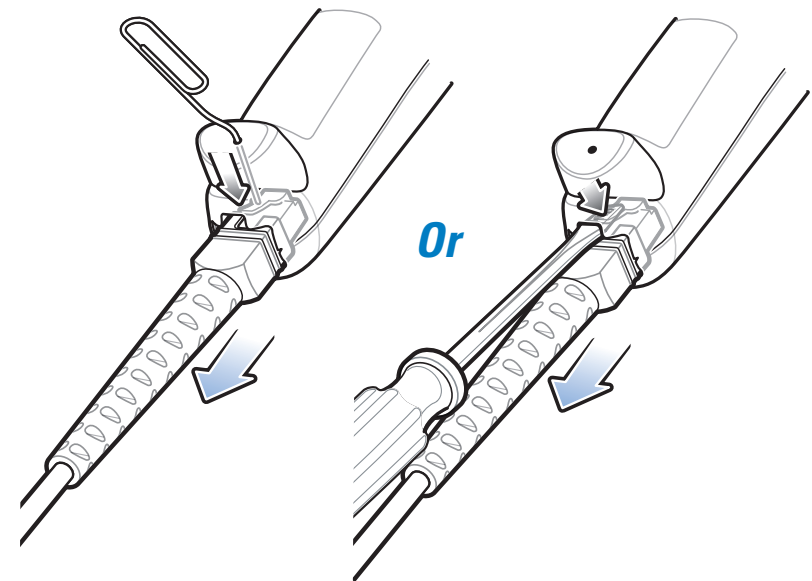

See Product Reference Guide for detailed information

STEP 2 - CONNECT CABLE TO A HOST

NOTE: Cables may vary depending on configuration.

USB

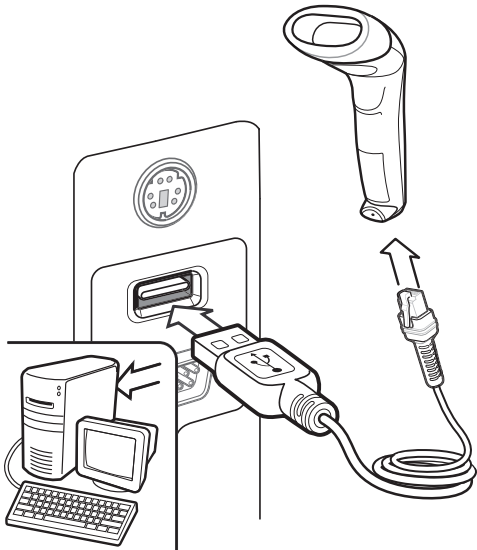

Keyboard Wedge

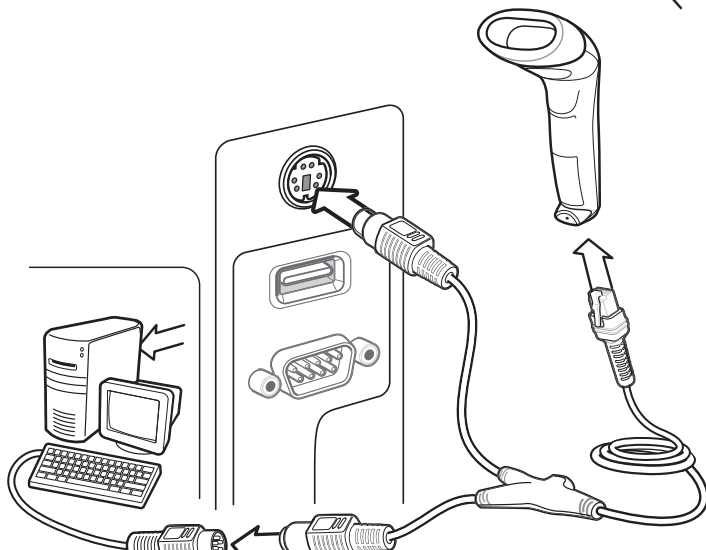

Note: Power Supply Optional

RS-232

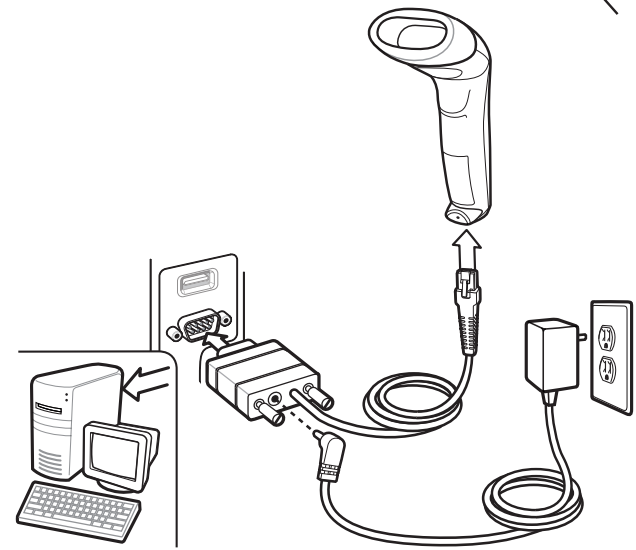

STEP 3 - SET UP INTERFACE (Scan Host Bar Codes)

Important: Out of box, Keyboard Wedge and USB interfaces require no bar code scan setup. Bar codes are provided for complex programming or interface changes.

USB

Scan **ONE** of the bar codes below



IBM HAND-HELD USB



HID KEYBOARD EMULATION

Keyboard Wedge

Scan **ONE** of the bar codes below



IBM AT Notebook



IBM PC/AT and IBM PC COMPATIBLE

RS-232

Scan **ONE** of the bar codes below



OPOS/JPOS



STANDARD RS-232

ADD AN ENTER KEY (CARRIAGE RETURN/LINE FEED)

Adding an **Enter** Key after scanned data; Scan all **THREE** bar codes in numerical order.

1



SCAN OPTIONS

2



<DATA><SUFFIX>

3



ENTER

ADD A TAB KEY

To add a **Tab** key after scanned data, scan all **THREE Enter** key bar codes above in numerical order then scan all **FIVE** bar codes below in numerical order.

1



SCAN SUFFIX

2



7

3



0

4



0

5



9

